

SOURCE FROM
CEMBERCI NEW YORK
OSMAN & OZLEM

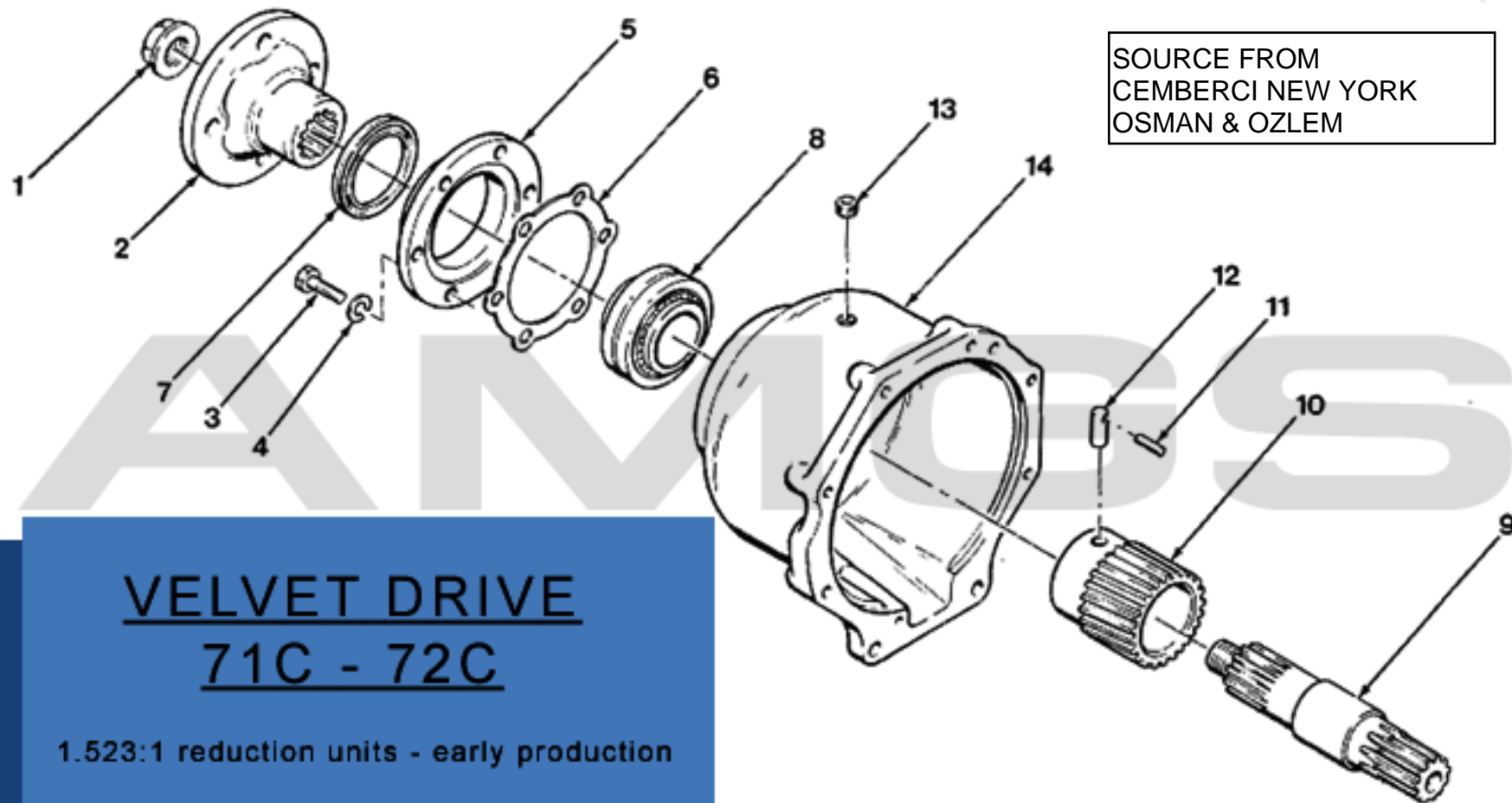

VELVET DRIVE 71C - 72C

1.523:1 reduction units - early production

VELVET DRIVE 71C - 72C

1.523:1 reduction units - current production

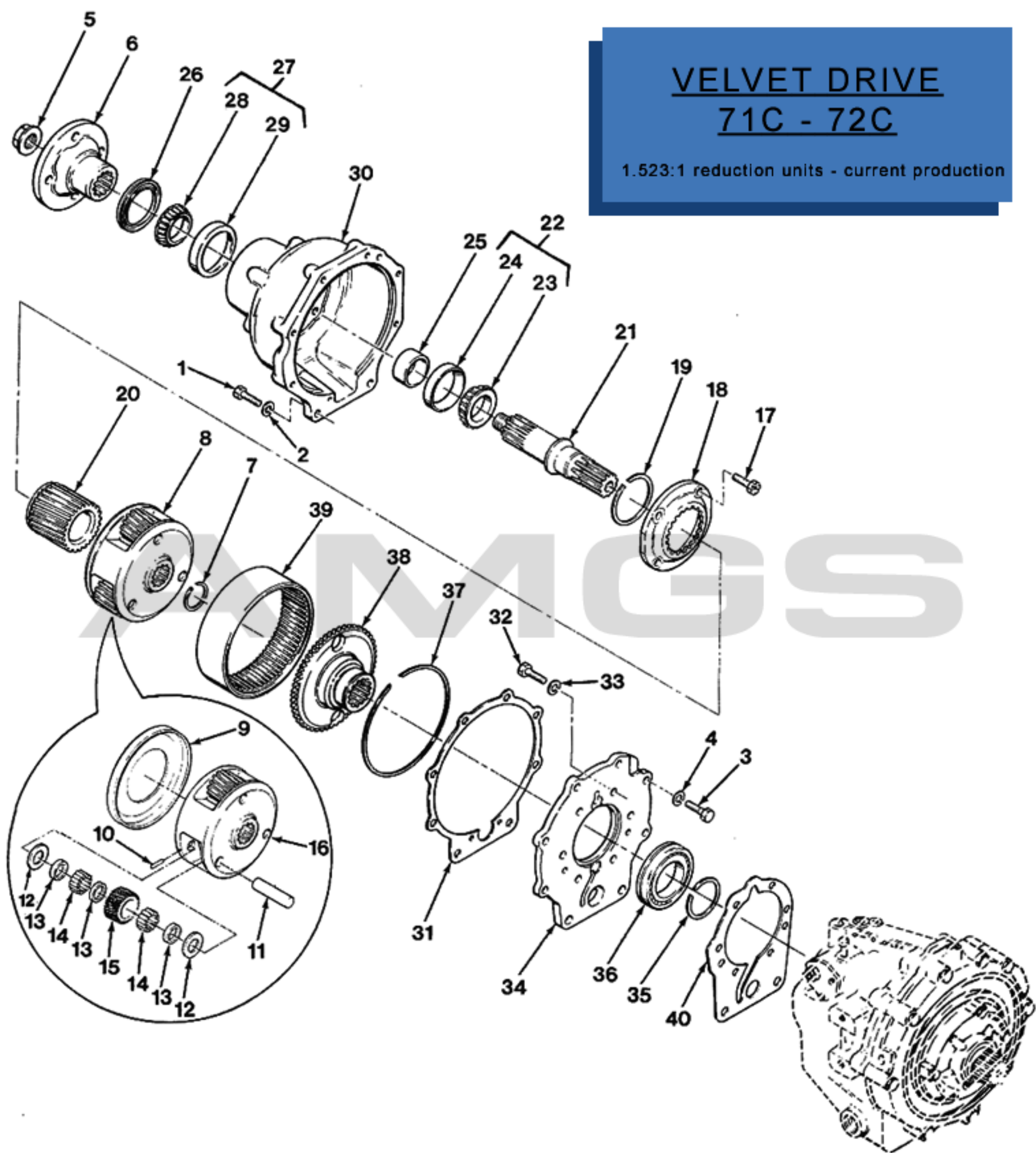

VELVET DRIVE 71C - 72C

2.10:1 reduction units - current production

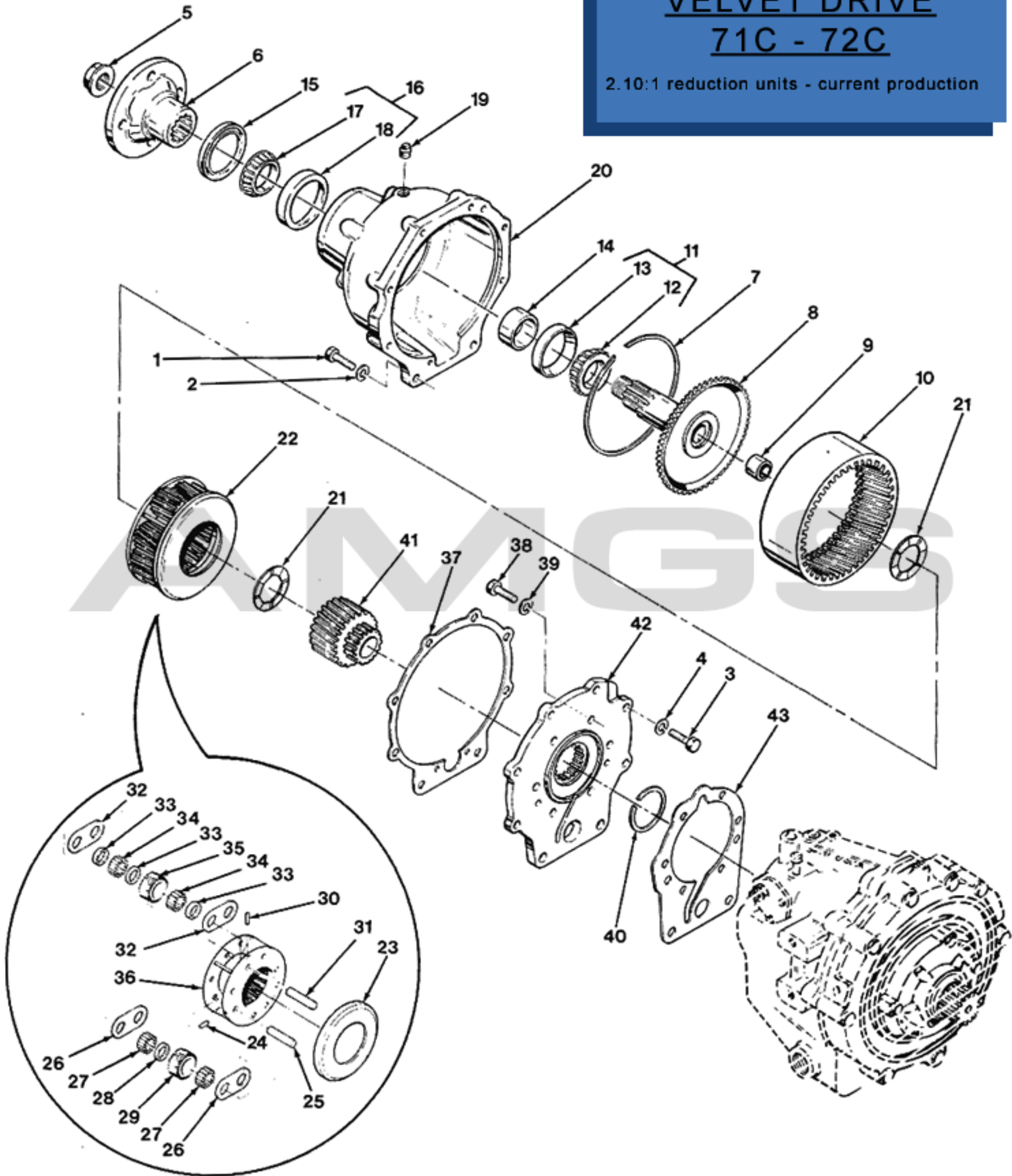

VELVET DRIVE 71C - 72C V-DRIVE

Forward & Reverse portion
or front half

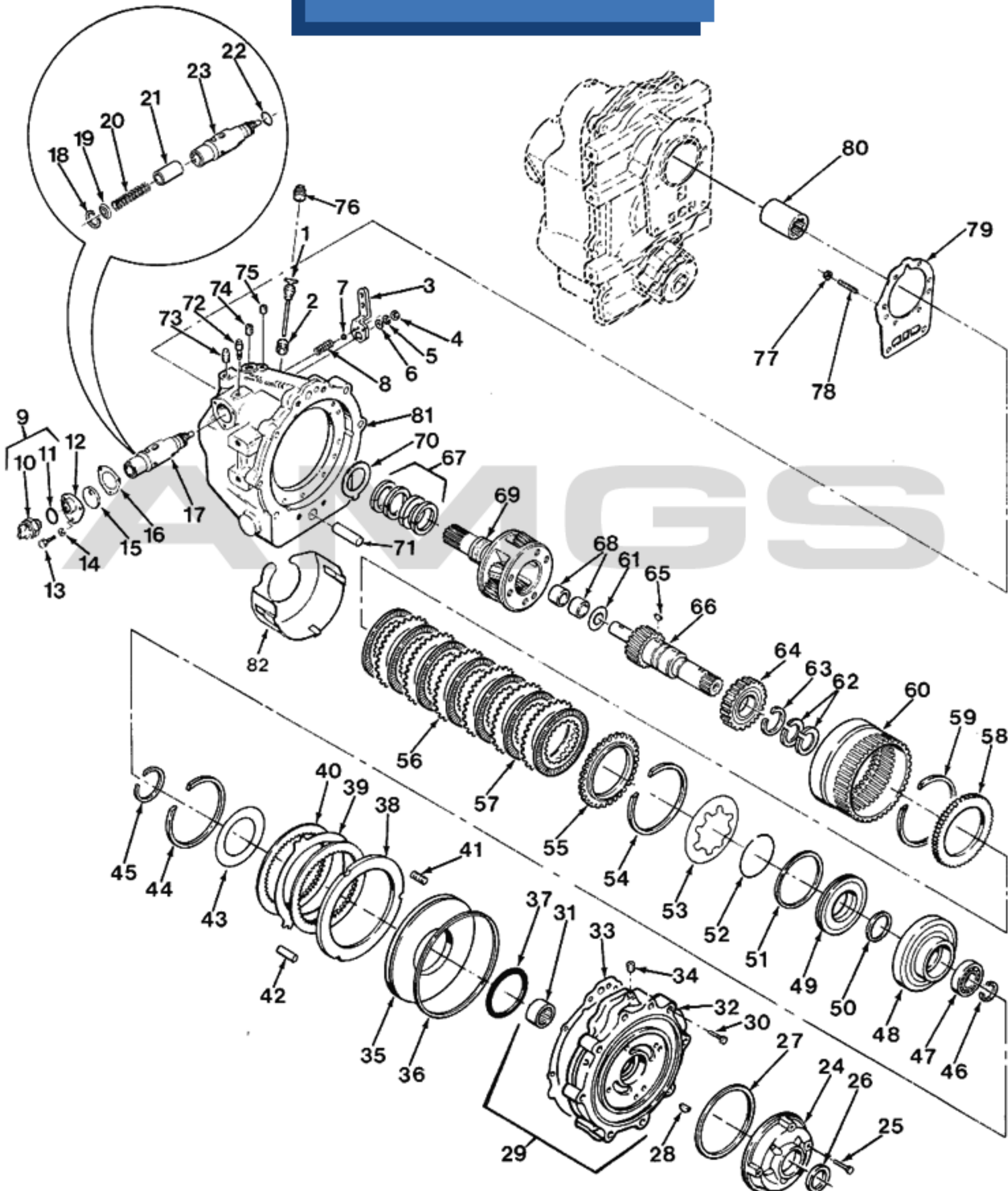

VELVET DRIVE 71C - 72C

Transmission Assembly - current production

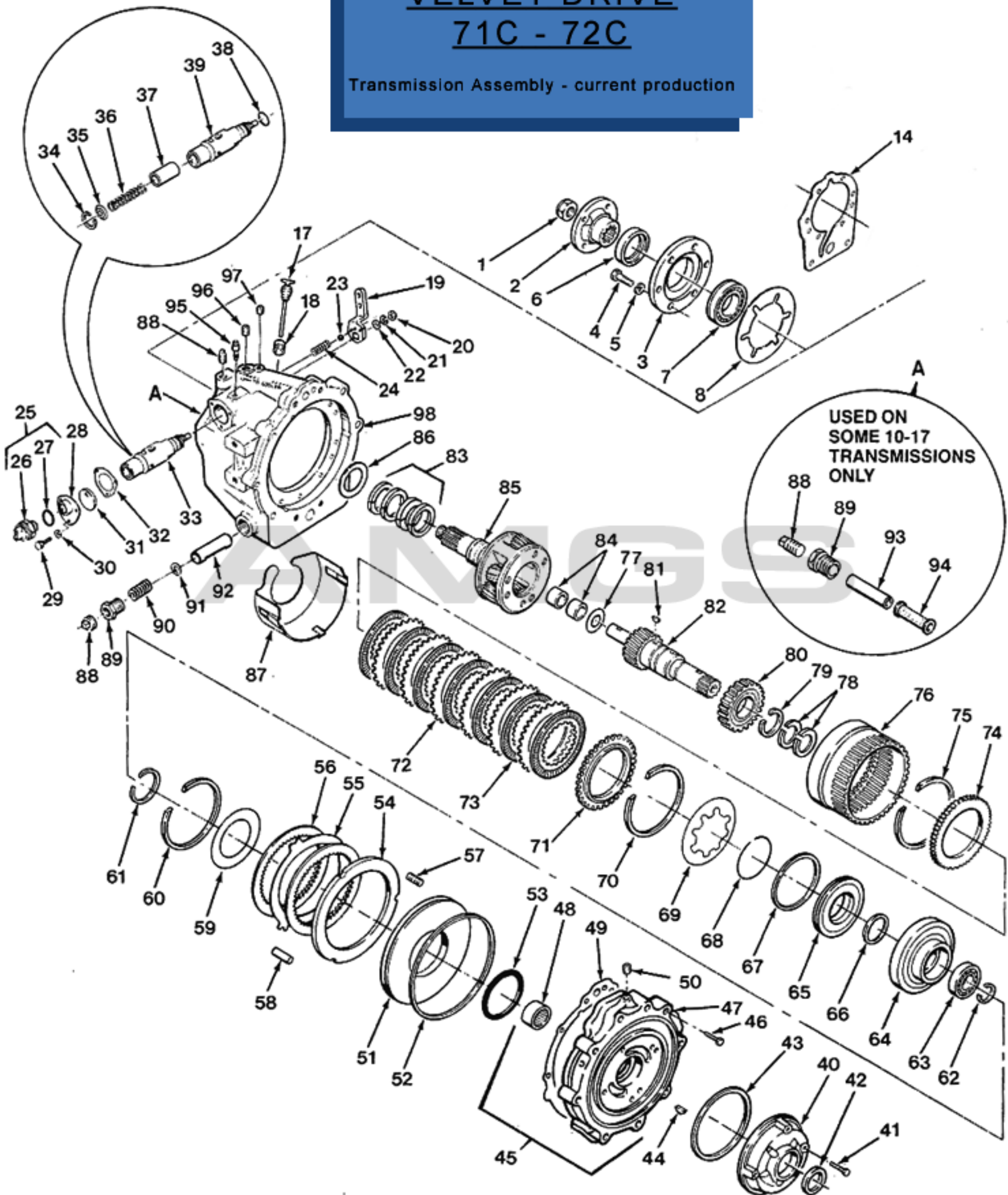

VELVET DRIVE 73C

1.50:1 reduction drive

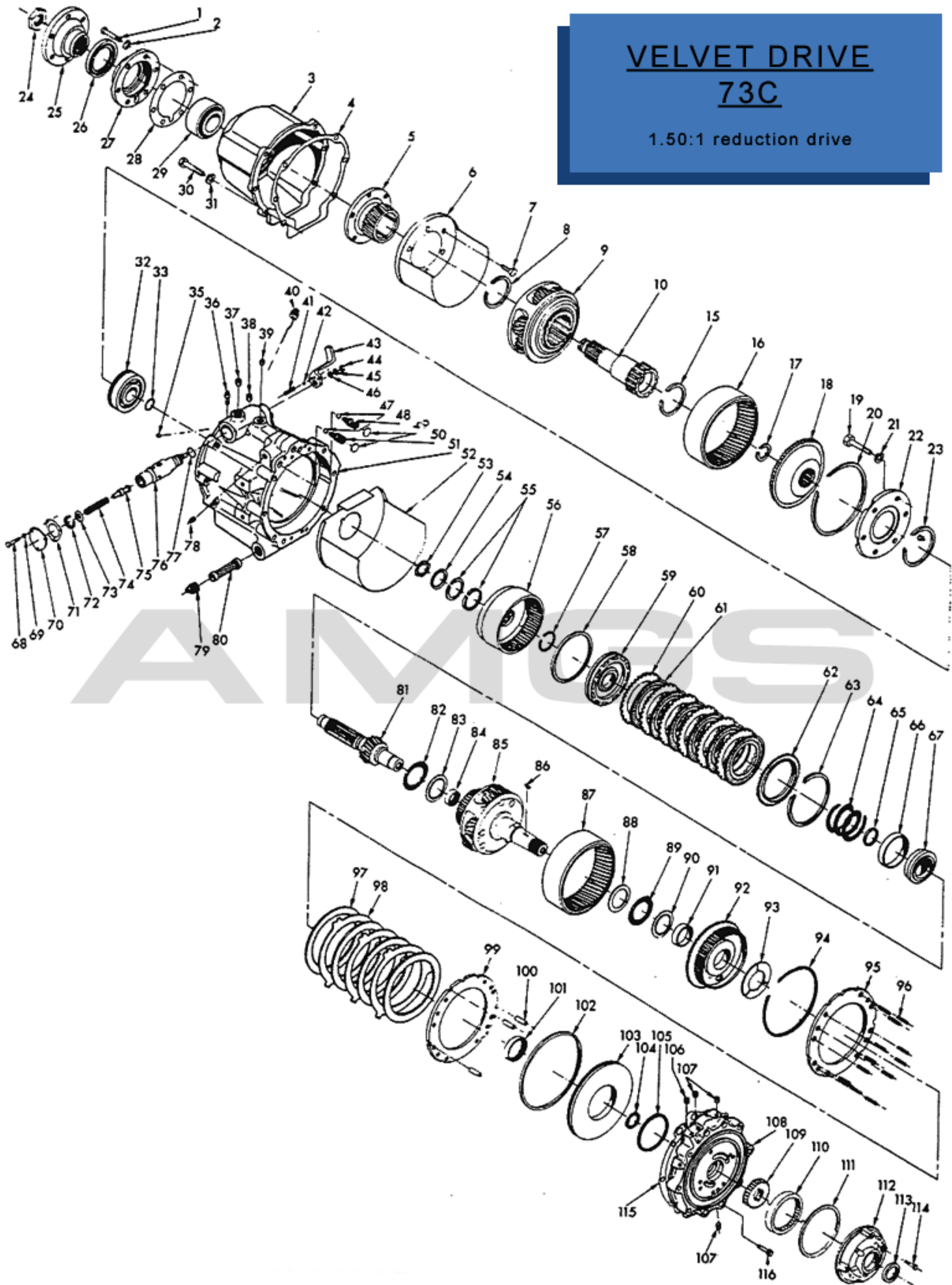

VELVET DRIVE 73C

2.00:1 reduction drive

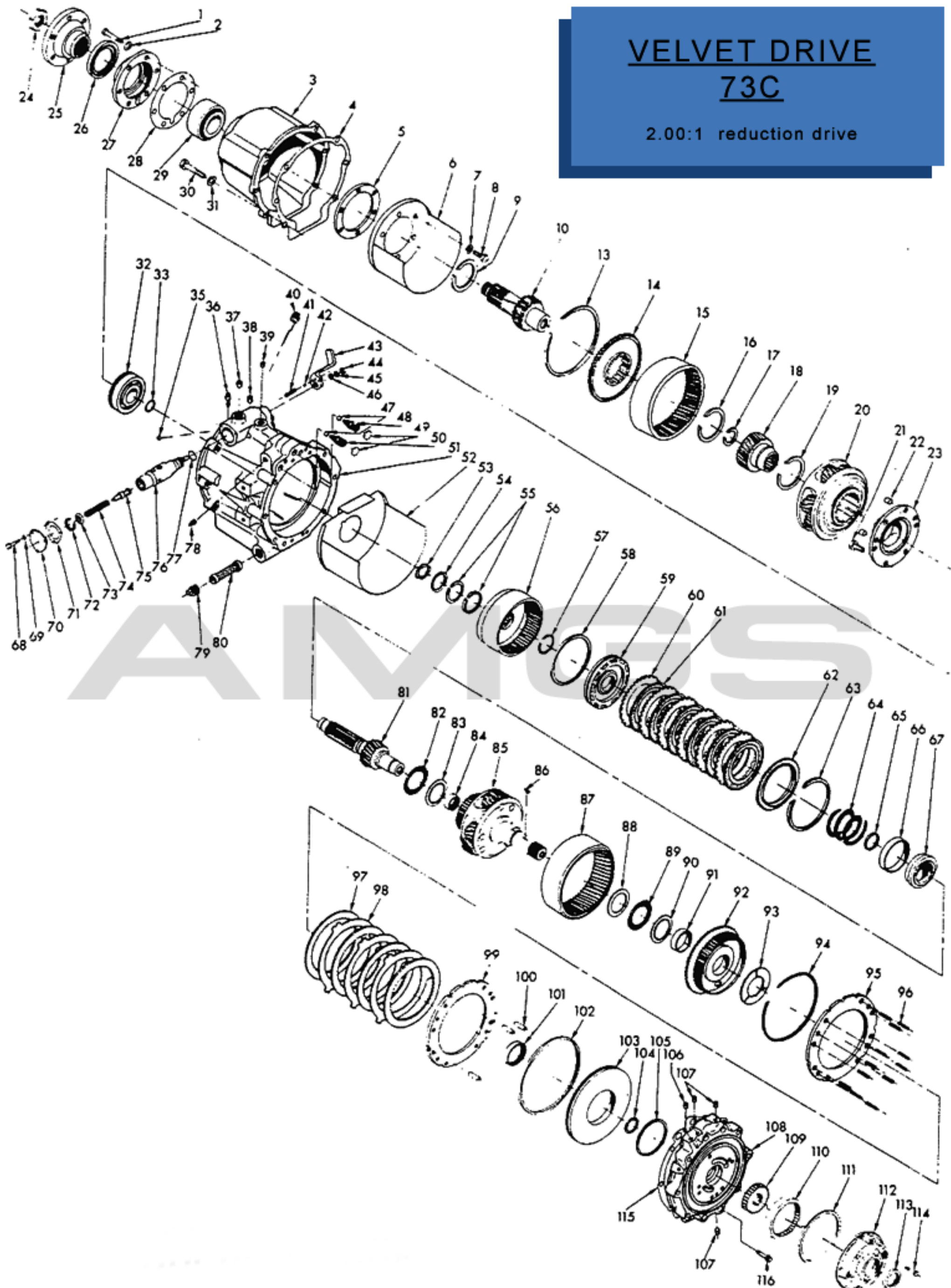

VELVET DRIVE

73C

3.00:1 reduction drive

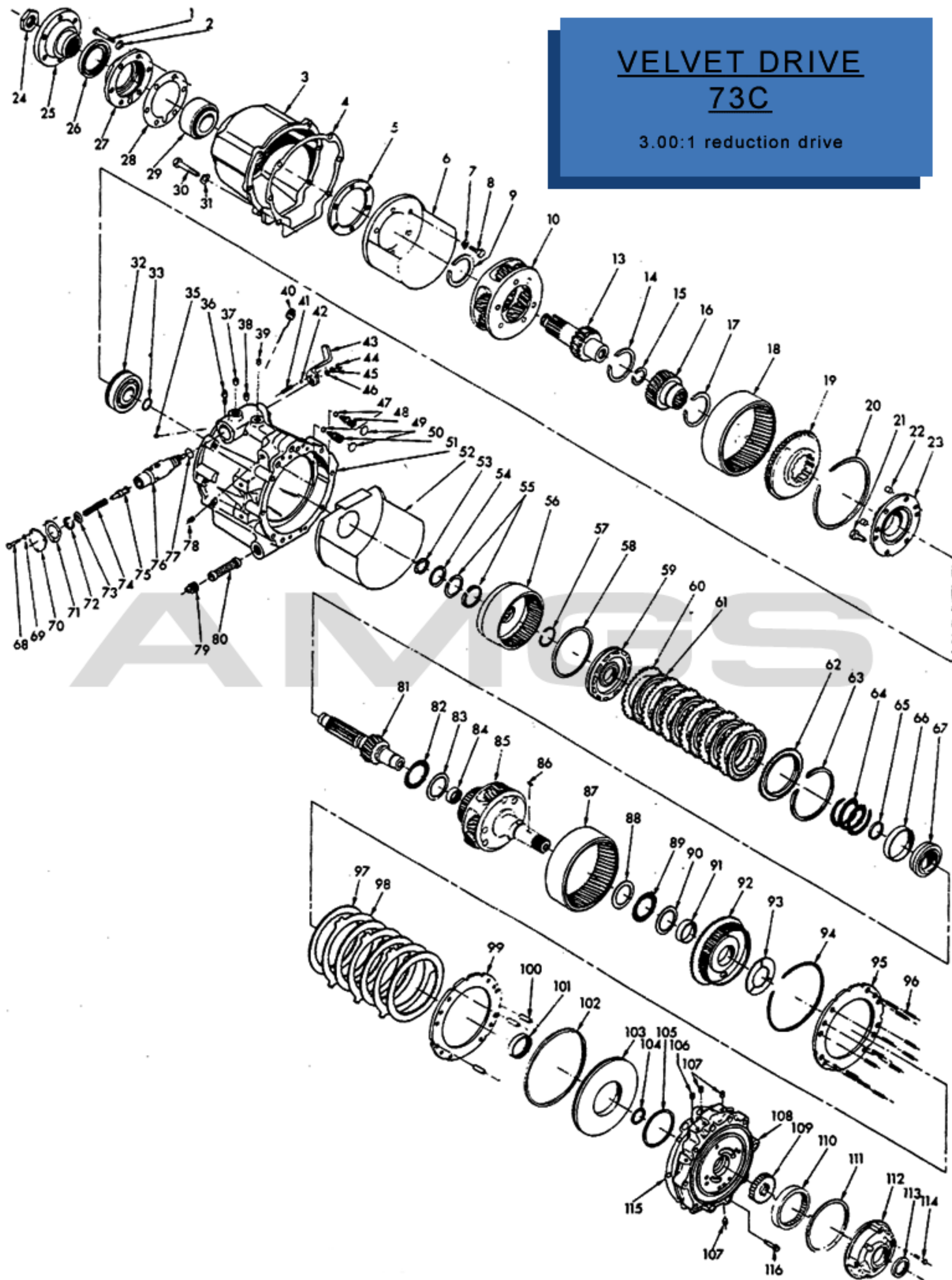

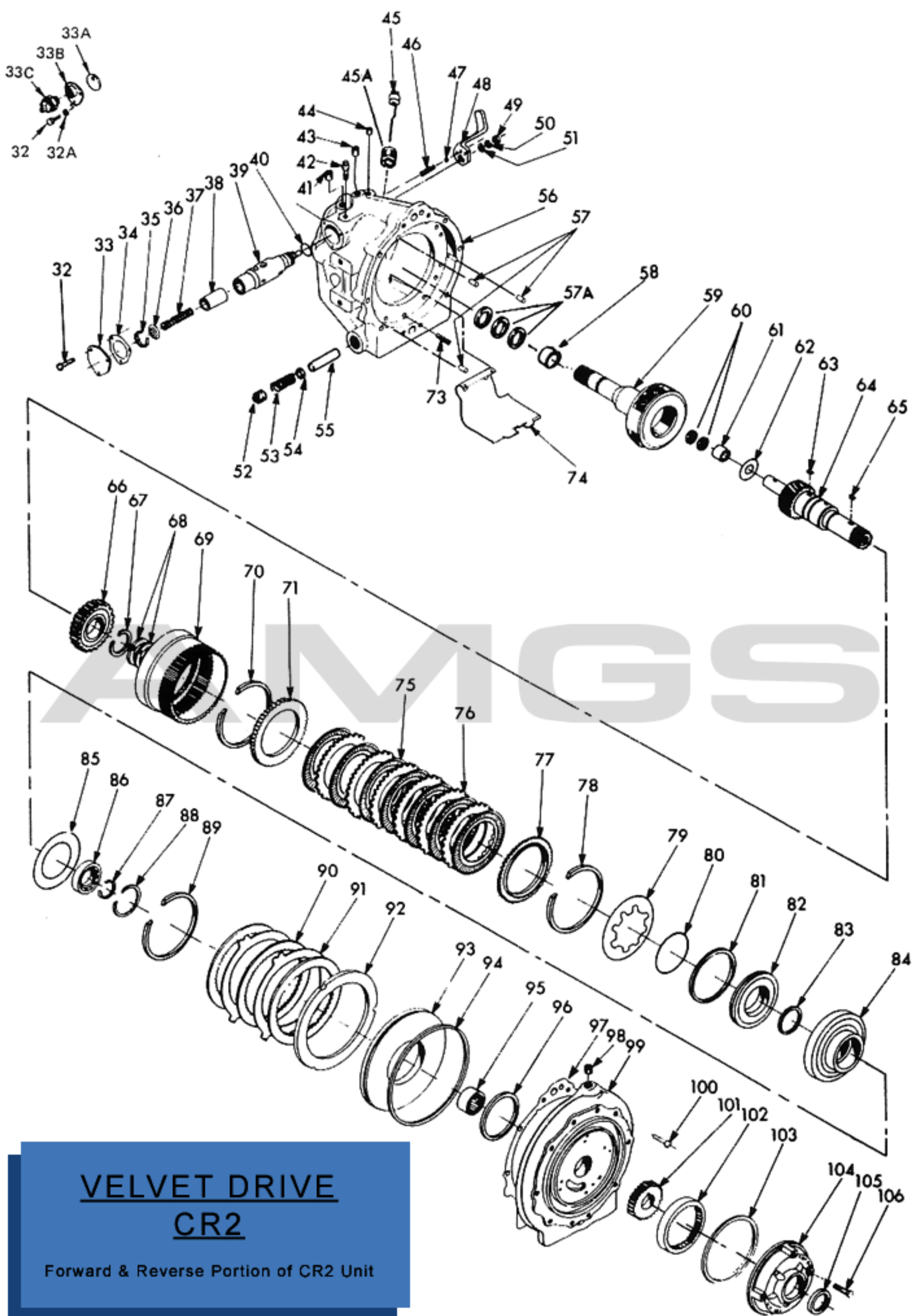

VELVET DRIVE CR2

Forward & Reverse Portion of CR2 Unit

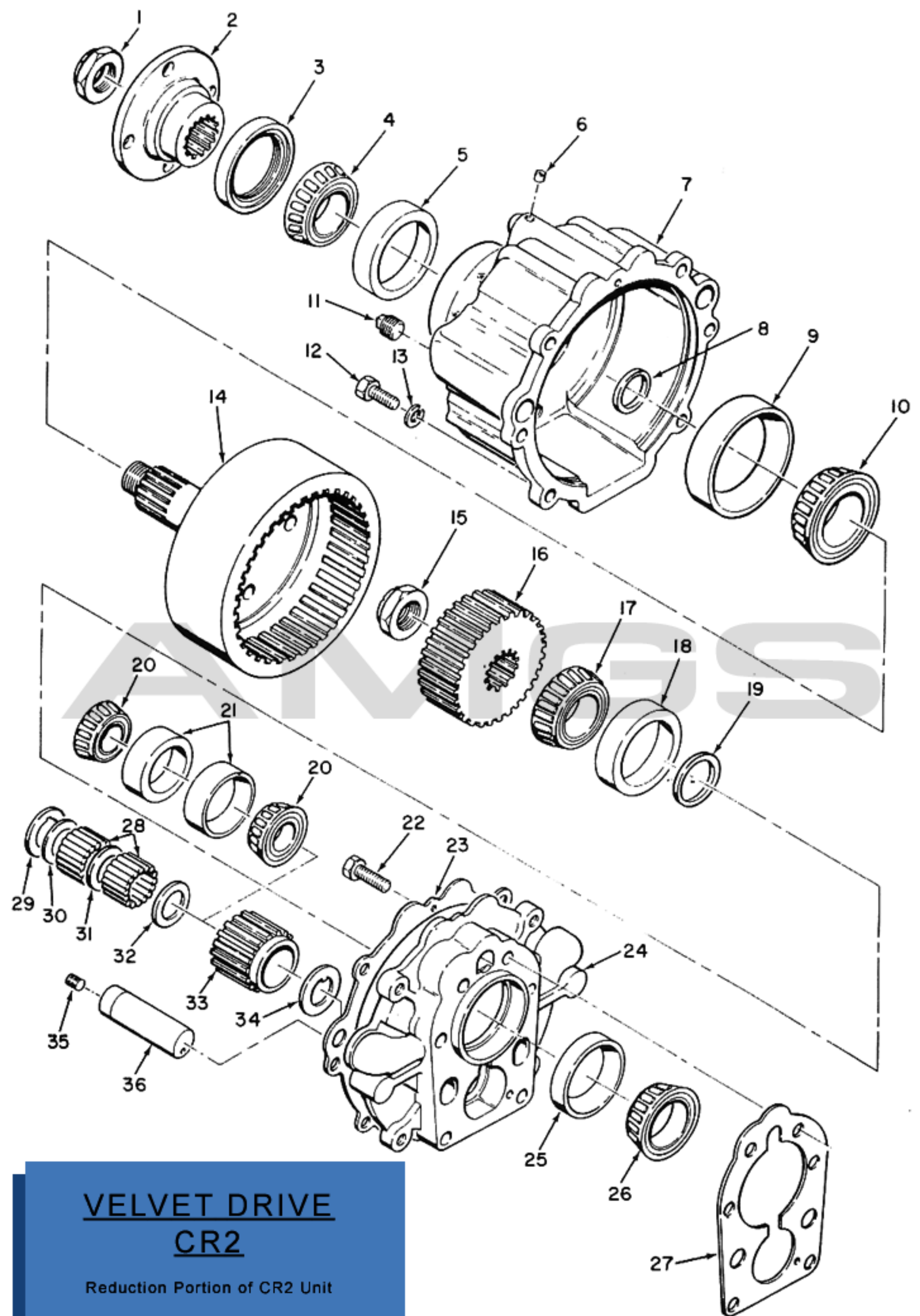

VELVET DRIVE CR2

Reduction Portion of CR2 Unit

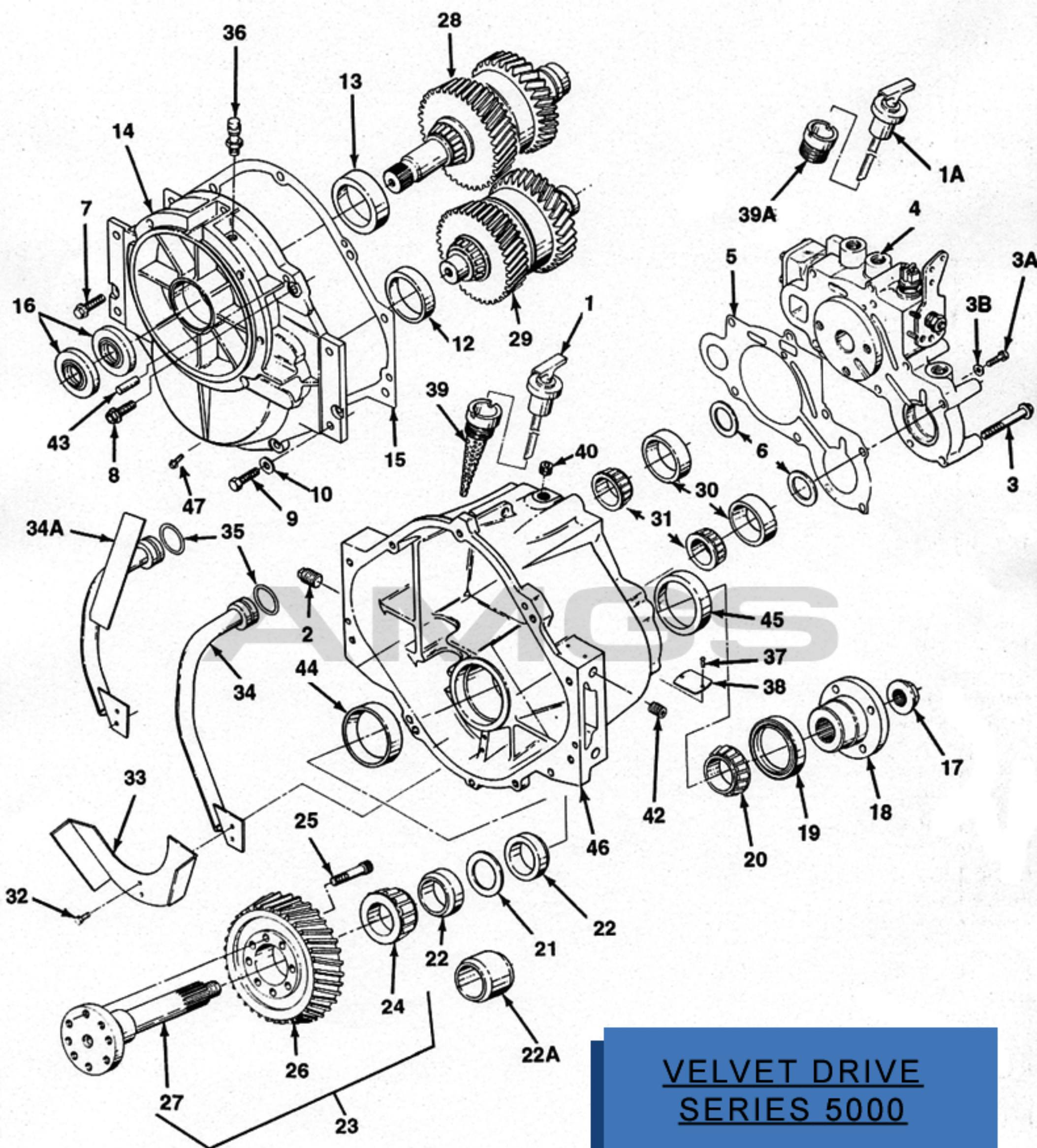

VELVET DRIVE SERIES 5000

transmission assembly

VELVET DRIVE SERIES 5000

input shaft assembly

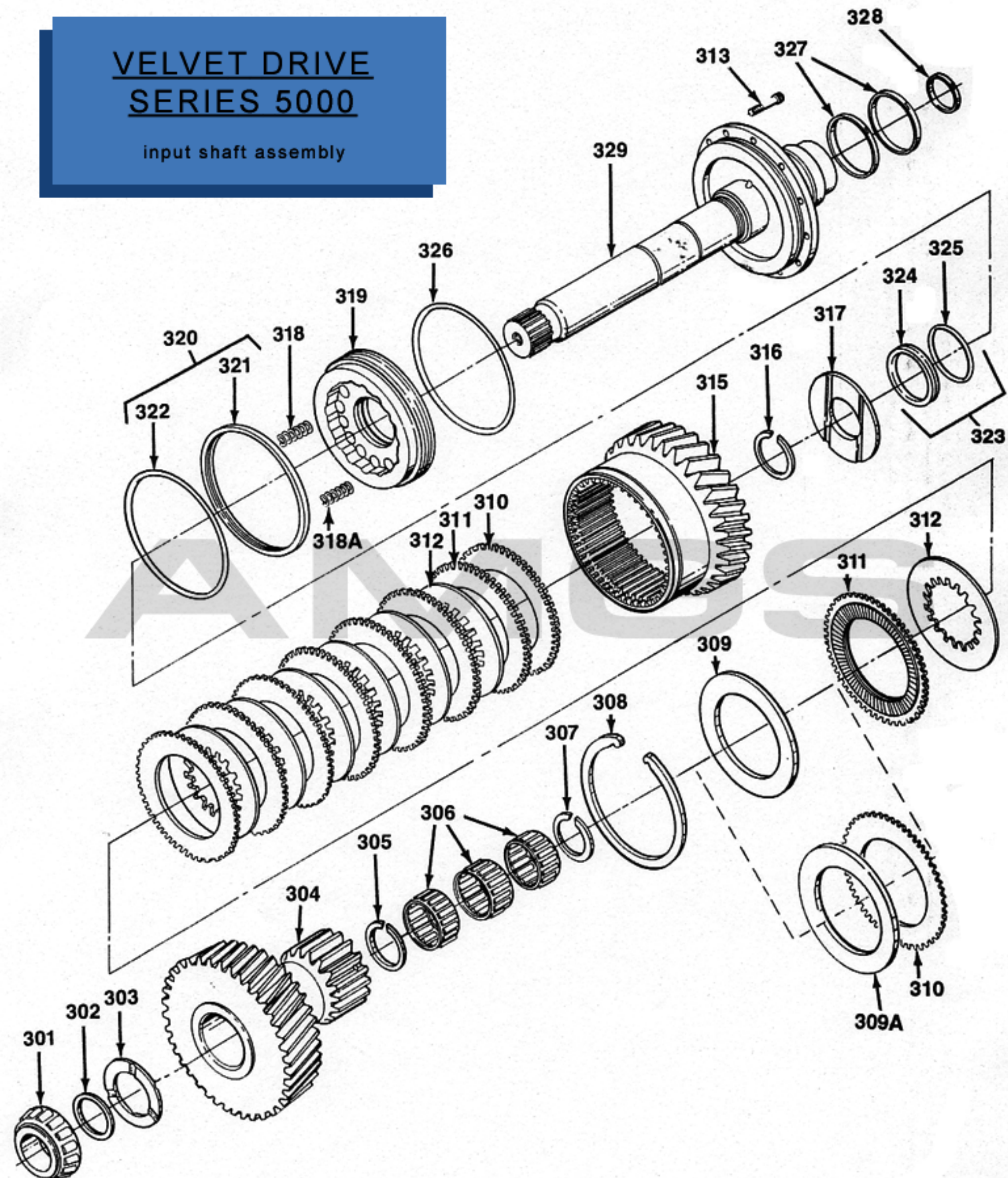

VELVET DRIVE SERIES 5000

lay shaft assembly

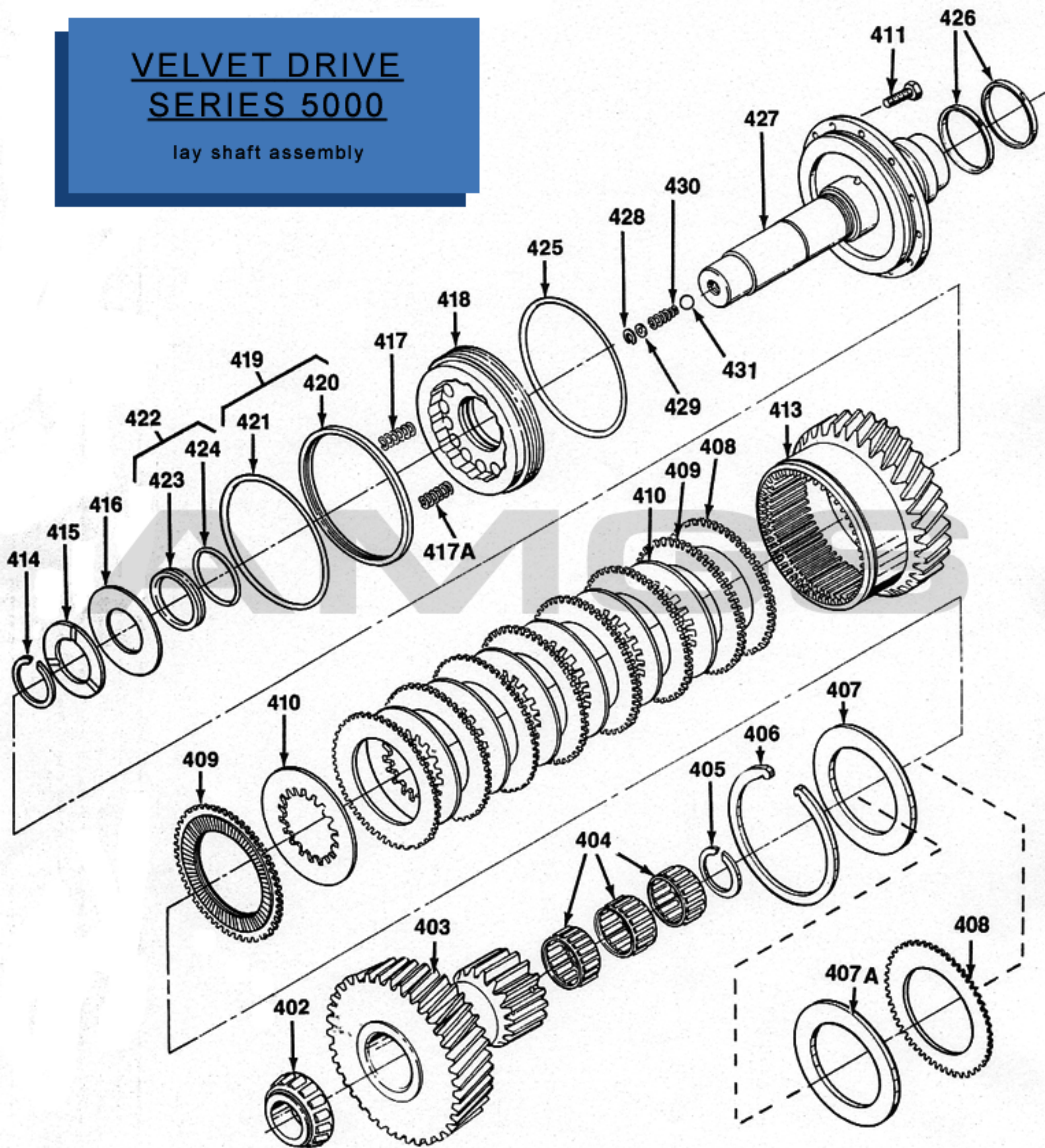

VELVET DRIVE SERIES 5000

valve and pump housing assembly

